

BODY

CONTENTS

| | | | |
|--------------------------------------|-----------|---------------------------------------|-----------|
| GENERAL | 2 | DOOR HANDLE AND LATCH | 17 |
| Outline of Changes | 2 | TRUNK LID | 19 |
| HOOD | 3 | TROUBLESHOOTING | 19 |
| FENDER | 4 | TRUNK LID | 19 |
| WINDOW GLASS | 5 | TRUNK LID LATCH | 21 |
| TAILGATE WINDOW GLASS | 5 | TAILGATE | 22 |
| DOOR | 7 | TROUBLESHOOTING | 22 |
| SERVICE SPECIFICATIONS | 7 | TAILGATE ASSEMBLY | 23 |
| TROUBLESHOOTING | 7 | TAILGATE TRIM | 25 |
| ON-VEHICLE SERVICE | 11 | TAILGATE LATCH | 26 |
| Door Outside Handle Play Check | 11 | KEYLESS ENTRY SYSTEM | 27 |
| Door Inside Handle Play Check | 11 | TROUBLESHOOTING | 27 |
| DOOR ASSEMBLY | 12 | ON-VEHICLE SERVICE | 29 |
| DOOR TRIM AND WATERPROOF | | Secret Code Registration Method | 29 |
| FILM | 13 | | |

GENERAL

OUTLINE OF CHANGES

The service procedures have been revised as the following parts or system have been changed:

- Hood panel
- Fender panel
- Tailgate window glass
- Front and rear door trims
- Front and rear door lock systems
- Trunk lid
- Tailgate

The troubleshooting for the central door locking system has been changed.

The circuit breaker for the power window motor has been controlled by the power window motor-ECU.

Troubleshooting has been revised as the theft-alarm system has been discontinued.

HOOD

REMOVAL AND INSTALLATION

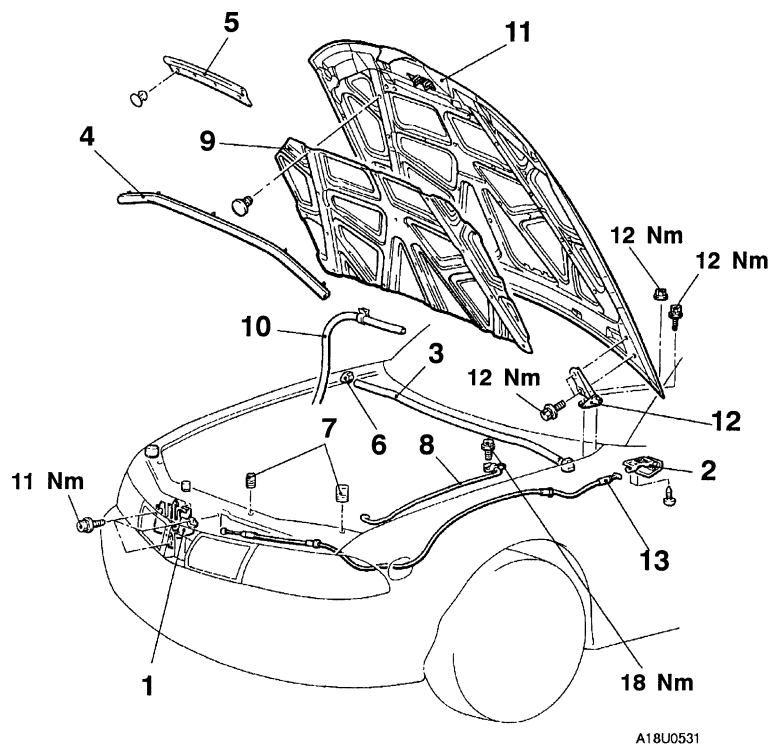

A18U0531

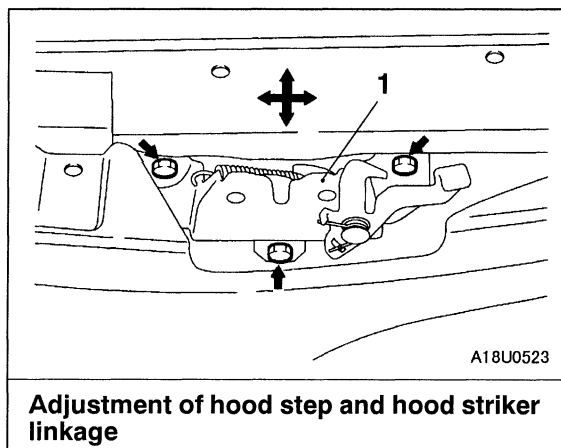
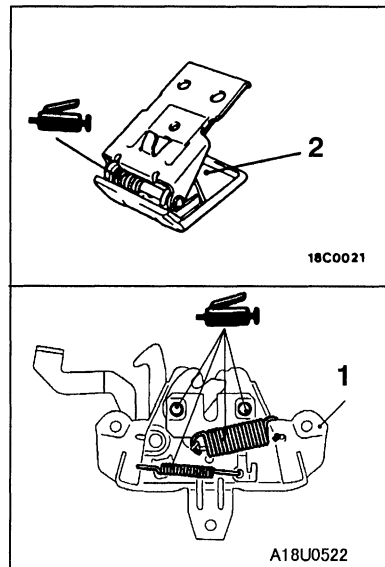

A18U0523

Adjustment of hood step and hood striker linkage

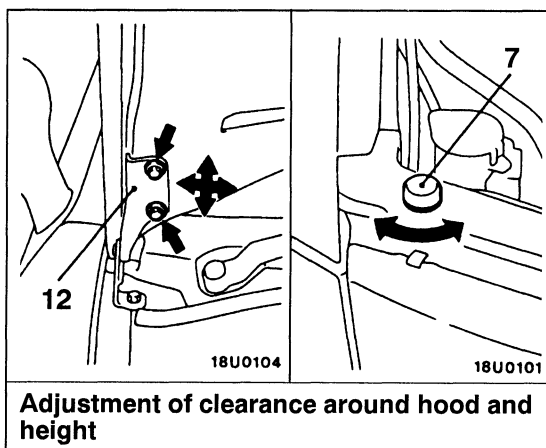

Adjustment of clearance around hood and height

1. Hood latch
2. Hood lock release handle
3. Hood weatherstrip A
4. Hood weatherstrip B
5. Hood weatherstrip C <GDI>
6. Hood side weatherstrip
7. Bumper
8. Hood support rod
9. Hood insulator

Hood and hood hinge removal steps

10. Washer hose connection
11. Hood
 - Front deck garnish (Refer to GROUP51.)
12. Hood hinge

Hood lock release cable removal steps

- Splash shield <Driver's side> (Refer to P.42-4.)
13. Hood lock release cable

FENDER

REMOVAL AND INSTALLATION

Pre-removal and Post-installation Operation

- (1) Front Bumper Removal and Installation
(Refer to GROUP 51.)
- (2) Headlamp Removal and Installation
(Refer to GROUP 54.)

- (3) Side Airdam Removal and Installation

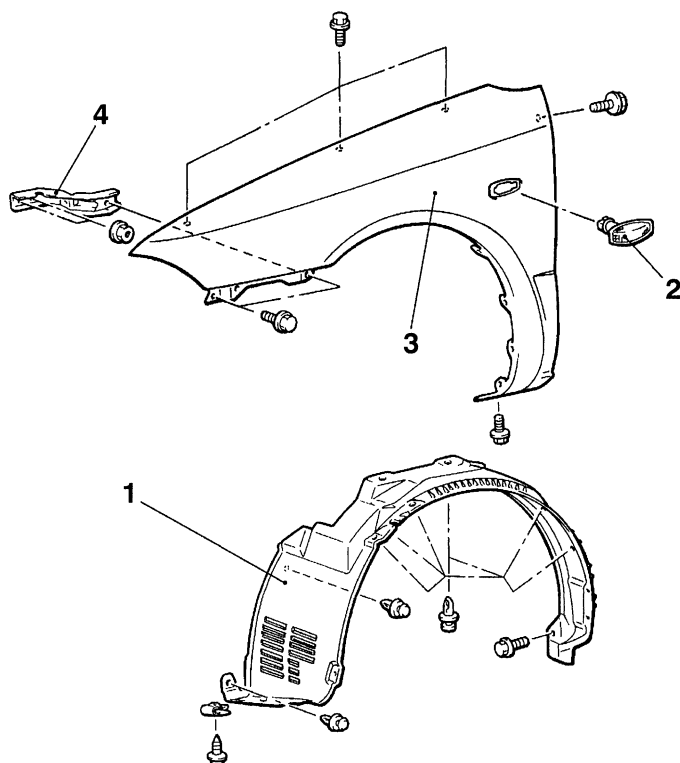

A18U0518

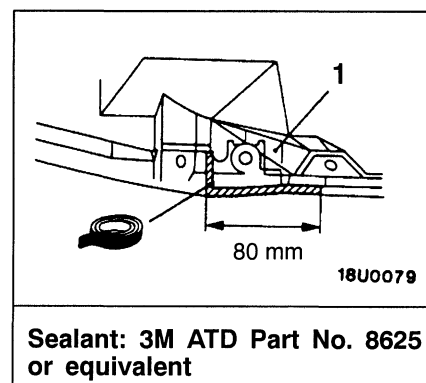

Removal steps

1. Splash shield
2. Side turn signal lamp
(Refer to GROUP 54.)

3. Fender
4. Fender support bracket

REMOVAL SERVICE POINT**◀A▶ TAILGATE WINDOW GLASS REMOVAL**

Remove the tailgate window glass by the same procedure as for the windshield. (Refer to '96 CARISMA Workshop Manual.)

INSTALLATION SERVICE POINTS**▶A◀ TAILGATE WINDOW GLASS INSTALLATION**

Apply primer and adhesive in the specified position, and then install the tailgate window glass by the same procedure as for the windshield. (Refer to '96 CARISMA Workshop Manual.)

DOOR

SERVICE SPECIFICATIONS

| Items | | Standard value |
|-----------------------------|------------|----------------|
| Door outside handle play mm | FRONT DOOR | 3.5–5.5 |
| | REAR DOOR | 3.0–6.0 |
| Door inside handle play mm | FRONT DOOR | 18.0–26.0 |
| | REAR DOOR | 15.0–19.0 |

TROUBLESHOOTING

INSPECTION CHART FOR TROUBLE SYMPTOMS

| Trouble symptom | | | Inspection procedure | Reference page |
|------------------------|---|---|----------------------|----------------|
| Power windows | Driver's power window cannot be operated by the power window main switch. | | 1 | *1 |
| | No power window can be operated by the power window main switch (but they can be operated by the sub-switches). | | 2 | *1 |
| | No power window can be operated by the power window sub-switches (but they can be operated by the main switch). | | 3 | *1 |
| | No power window can be operated by the power window sub-switches (nor can they be operated by the main switch). | | 4 | *1 |
| | Automatic operation is not possible. | | 5 | *1 |
| | When the glass is raised, it then lowers automatically. | | 6 | *1 |
| | The window does not lower if it clamps something, or it lowers automatically after closing fully. | | 7 | *1 |
| | The key off timer does not operate. | | 8 | *1 |
| | If the driver's side door is opened while the key off timer is operating, the power windows do not operate for a further 30 seconds after the door is opened. | | 9 | *1 |
| Door locking mechanism | Vehicles without keyless entry system | None of the door lock functions operate. | 10 | *2 |
| | | Doors do not lock or unlock when the key cylinders (except the one at the driver's side door) are operated. | 11 | 42-7 |
| | | Some doors do not lock or unlock. | 12 | 42-8 |
| | Vehicles with keyless entry system | None of the door lock functions operate. (The keyless entry system also does not operate.) | 13 | 42-8 |
| | | The doors do not lock or unlock when the key cylinders are operated. | 14 | 42-9 |
| | | Some doors do not lock or unlock. | 15 | 42-9 |

NOTE

*1: Refer to '96 CARISMA Workshop Manual (Pub. No. PWDE9502).

*2: Refer to '98 CARISMA (except GDI) Workshop Manual (Pub. No. PWDE9502-B).

INSPECTION CHART FOR TROUBLE SYMPTOMS

Inspection Procedure 11

| Doors do not lock or unlock when the key cylinders (except the one at the driver's side door) are operated. | Probable cause |
|---|--|
| The key cylinder switch or the door lock-ECU may be defective. | <ul style="list-style-type: none"> • Malfunction of the door lock key cylinder switch • Malfunction of the tailgate lock key cylinder switch • Malfunction of the trunk lid lock key cylinder switch • Malfunction of the door lock-ECU • Malfunction of harness or connector |

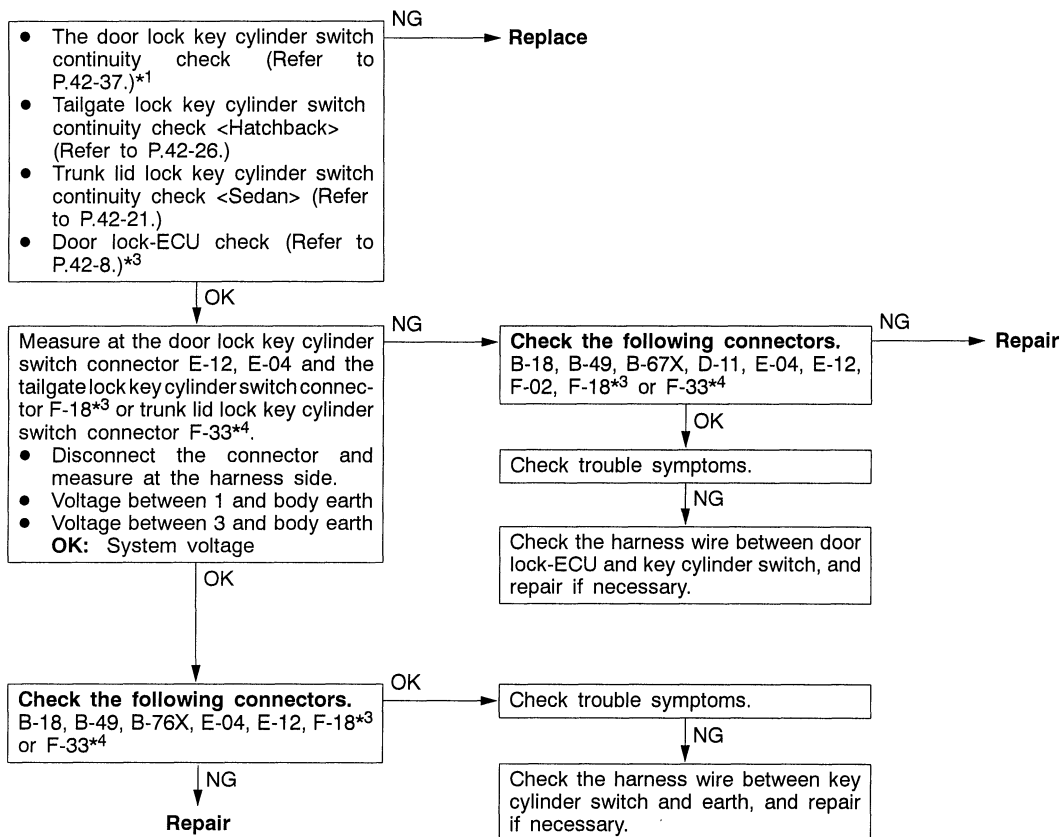

NOTE

*1: Refer to '96 CARISMA Workshop Manual (Pub. No. PWDE9502).

*2: Refer to '98 CARISMA (except GDI) Workshop Manual (Pub. No. PWDE9502-B).

*3: Hatchback

*4: Sedan

Inspection Procedure 12

| Some doors do not lock or unlock. | Probable cause |
|--|---|
| The door lock actuator, a harness or connector may be defective. | <ul style="list-style-type: none"> • Malfunction of door lock actuator • Malfunction of wiring harness or connector |

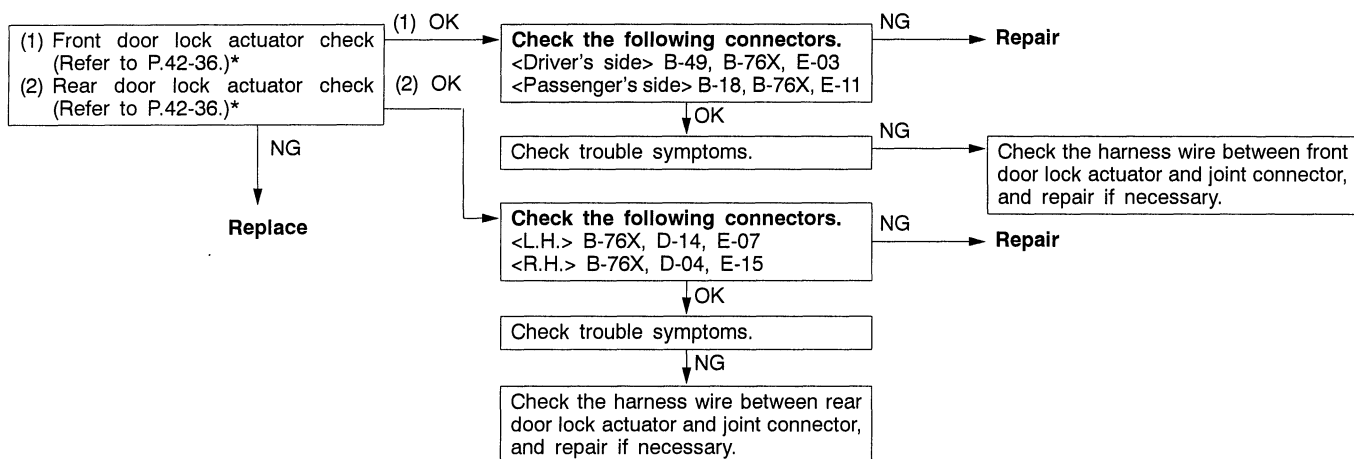

NOTE

*: Refer to '96 CARISMA Workshop Manual (Pub. No. PWDE9502).

Inspection Procedure 13

| None of the door lock functions operate.(The keyless entry system does not operate,either.) | Probable cause |
|--|---|
| Power circuit system or earth circuit system of the keyless entry receiver-ECU may be defective. | <ul style="list-style-type: none"> • Malfunction of keyless entry receiver-ECU • Malfunction of wiring harness or connector |

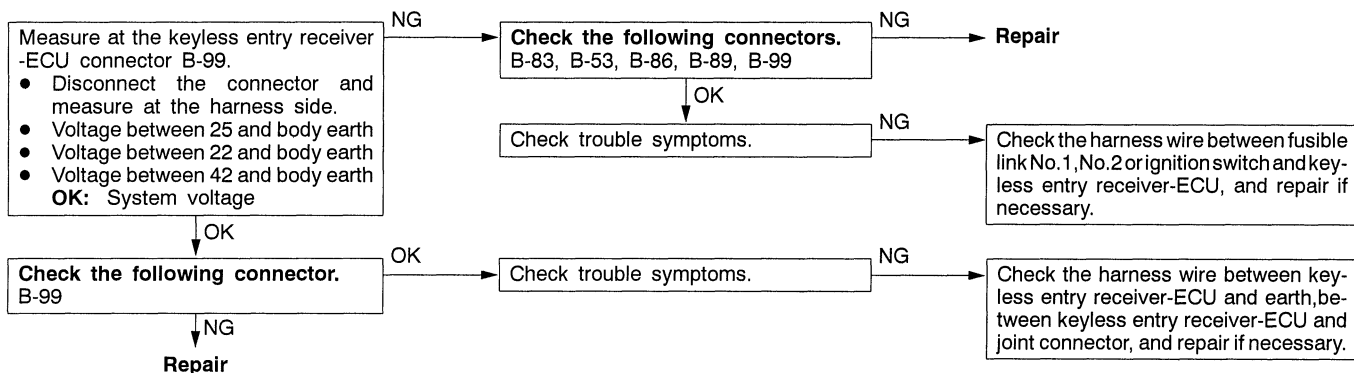

NOTE

If the keyless entry or central door locking system is operated while the No.2 fuse in the junction block is melted or disconnected, the keyless entry receiver-ECU judges its circuit as defective. Then the system will not function after connecting No.2 fuse correctly. In this case, the wiring harness abnormal signal is stored inside the ECU. This signal can be cleared by disconnecting and reconnecting the No.3 fuse in the engine compartment relay box. After clearing this signal, the system will be restored.

Inspection Procedure 14

| The doors do not lock or unlock when the key cylinders are operated. | Probable cause |
|---|---|
| The keyless entry receiver-ECU or the key cylinder switch may be defective. | <ul style="list-style-type: none"> • Malfunction of the door lock key cylinder switch • Malfunction of the tailgate lock key cylinder switch • Malfunction of the trunk lid lock key cylinder switch • Malfunction of the keyless entry receiver-ECU • Malfunction of harness or connector |

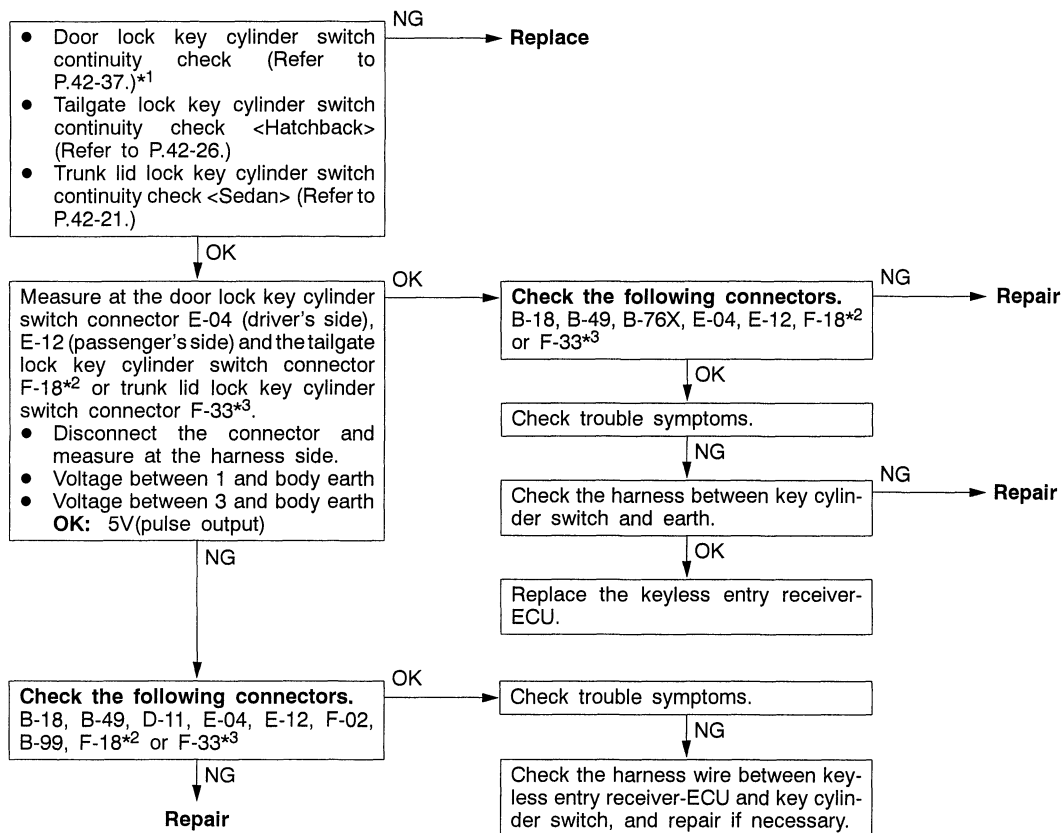

NOTE

*1: Refer to '96 CARISMA Workshop Manual (Pub. No. PWDE9502).

*2: Hatchback

*3: Sedan

Inspection Procedure 15

| Some doors do not lock or unlock. | Probable cause |
|--|---|
| The door lock actuator, a harness or connector may be defective. | <ul style="list-style-type: none"> • Malfunction of door lock actuator • Malfunction of wiring harness or connector |

INSPECTIONPROCEDURE 12 FORTROUBLESYMPTOMS
(Refer to P.42-9.)

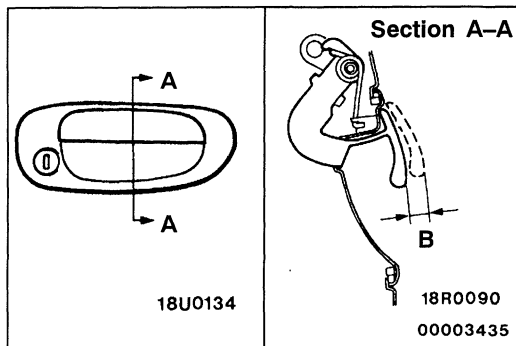

ON-VEHICLE SERVICE

DOOR OUTSIDE HANDLE PLAY CHECK

1. Check that the door outside handle play is within the standard value range.

Standard value (B):

FRONT DOOR 3.5 – 5.5 mm

REAR DOOR 3.0 – 6.0 mm

2. If the door outside handle play is not within the standard value range, check the door outside handle or the door latch assembly. Replace, if necessary.

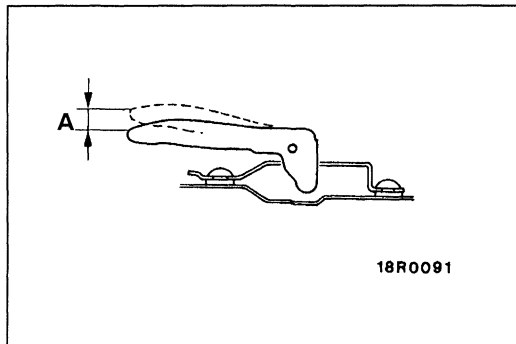

DOOR INSIDE HANDLE PLAY CHECK

1. Check that the door inside handle play is within the standard value range.

Standard value (A):

FRONT DOOR 18.0 – 26.0 mm

REAR DOOR 15.0 – 19.0 mm

2. If the door inside handle play is not within the standard value range, check the door inside handle or the door latch assembly. Replace, if necessary.

DOOR ASSEMBLY

REMOVAL AND INSTALLATION

Post-installation Operation
Door Adjustment.

Front door

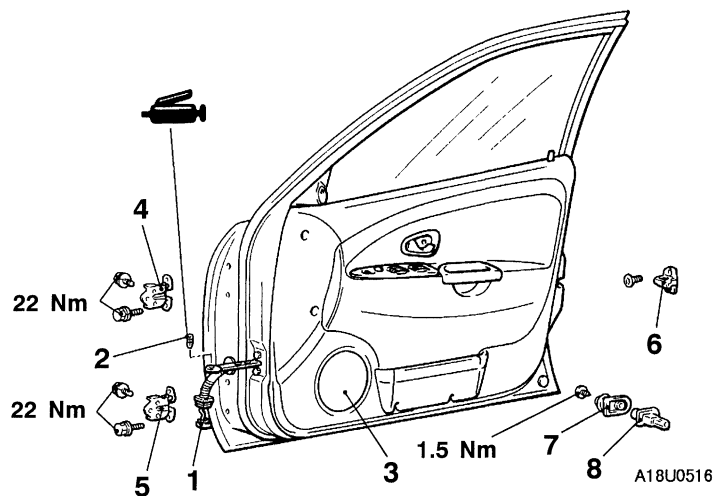

Rear door

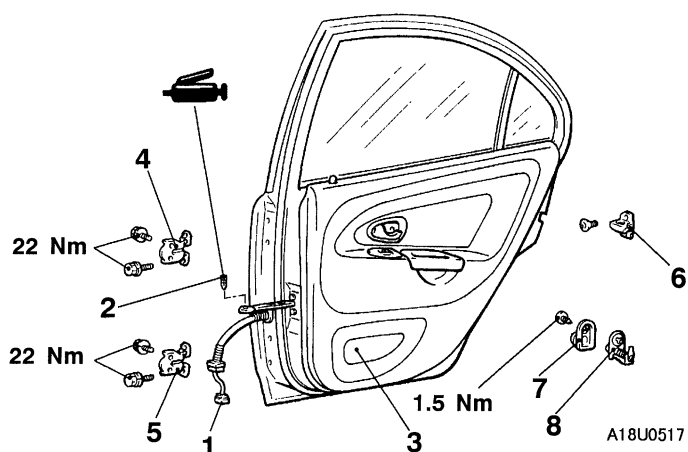

Door assembly removal steps

1. Harness connector
2. Spring pin
3. Door assembly
4. Door upper hinge
5. Door lower hinge

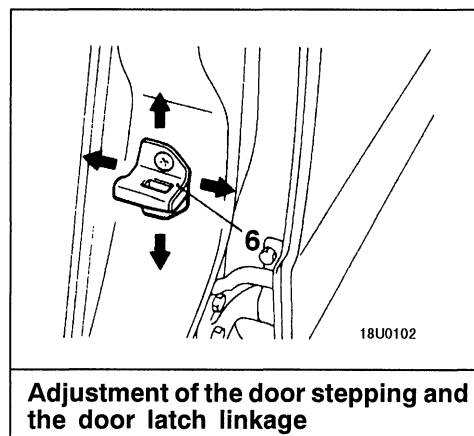

Adjustment of the door stepping and the door latch linkage

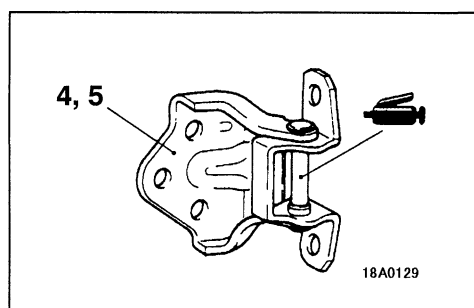

Striker removal

6. Striker

Door switch removal steps

7. Door switch cap
8. Door switch

DOOR TRIM AND WATERPROOF FILM REMOVAL AND INSTALLATION

Front door

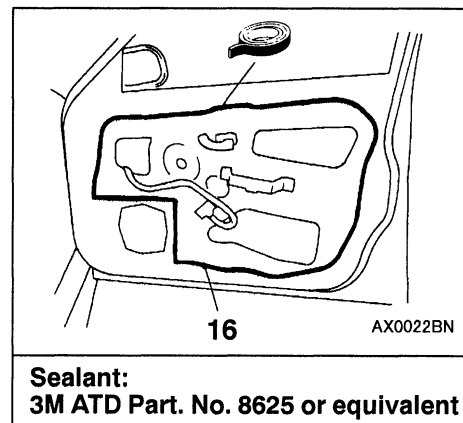
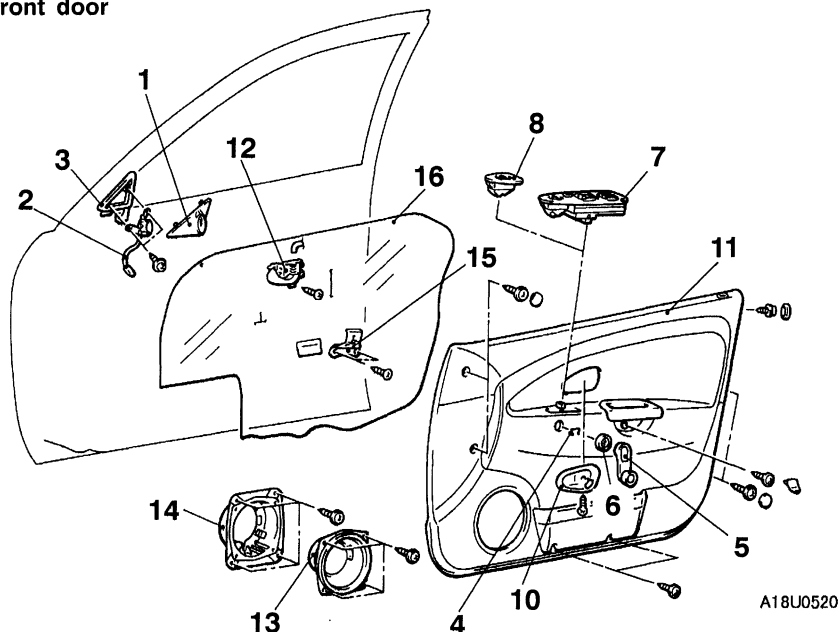

Rear door

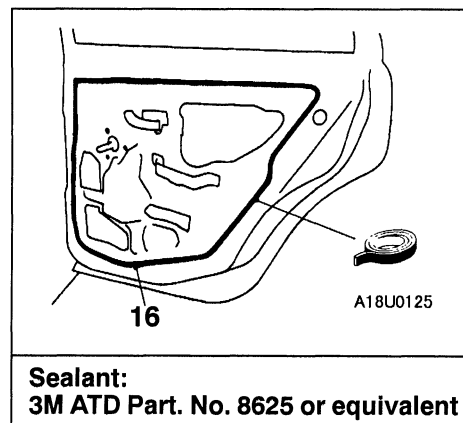
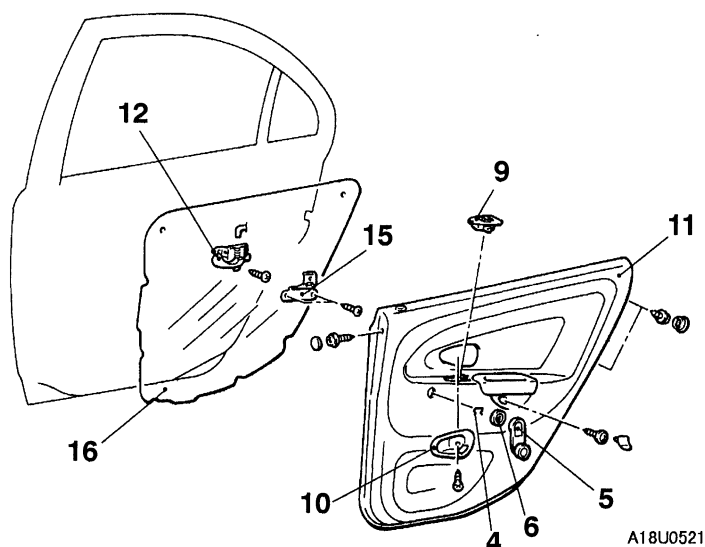

Removal steps

1. Delta cover inner lid
2. Tweeter assembly
3. Delta cover inner frame
4. Clip
<Vehicles without power windows>
5. Regulator handle
<Vehicles without power windows>
6. Escutcheon
<Vehicles without power windows>
7. Power window main switch
<Vehicles with power windows>

8. Central door lock switch
<Vehicles without power windows>
9. Power window sub switch
<Vehicles without power windows>
10. Cover
11. Door trim
12. Door inside handle
13. Speaker
14. Speaker bracket
15. Pull handle bracket
16. Waterproof film

◀A▶

▶A▶

◀B▶

◀C▶

CLIP AND CLAW POSITIONS <FRONT DOOR>

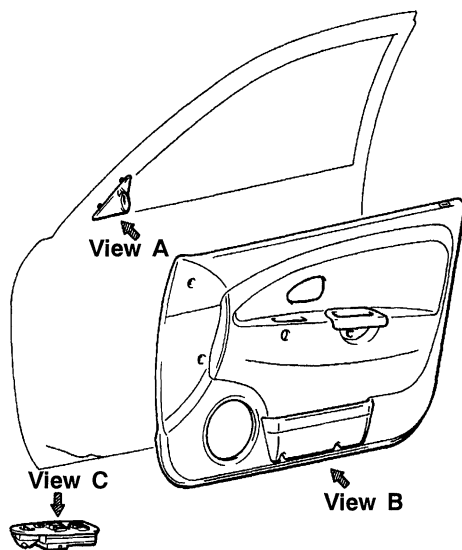

A18U0552

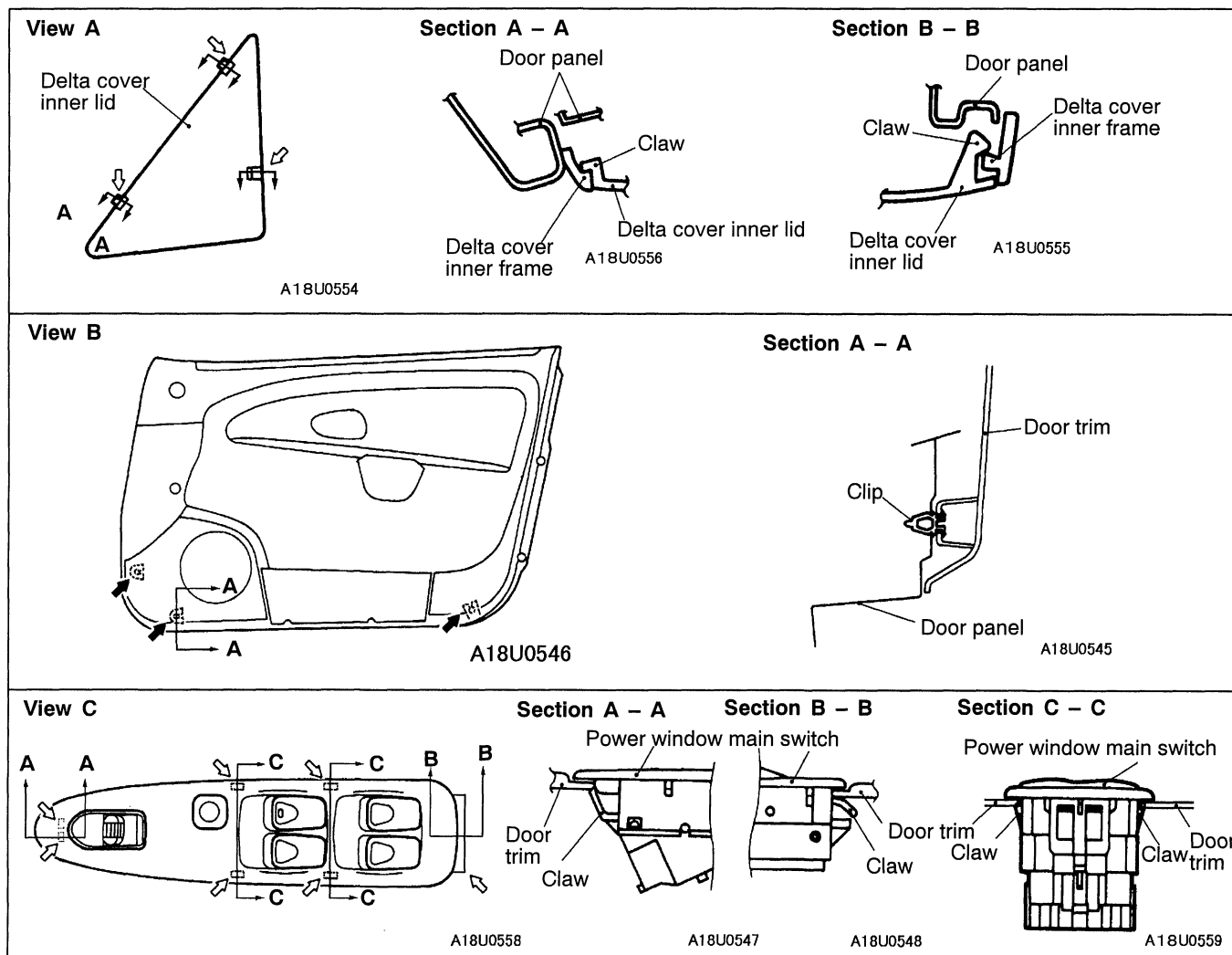

NOTE

◄ : Resin clip positions

◁ : Claw positions

CLIP AND CLAW POSITIONS <REAR DOOR>

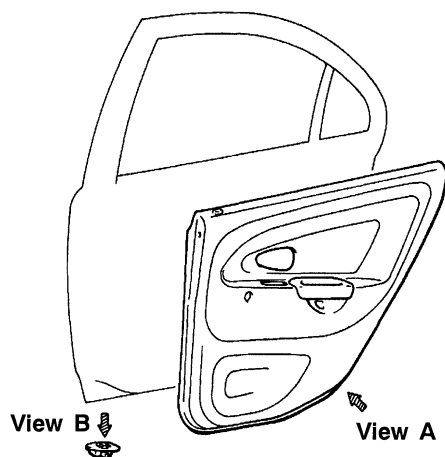

A18U0553

View A

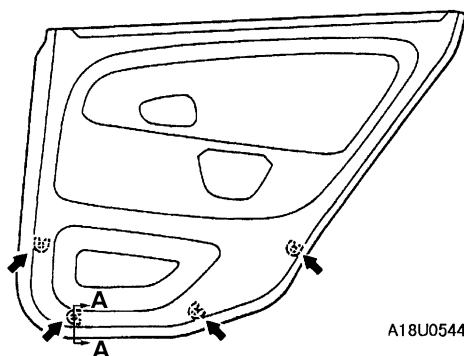

A18U0544

Section A – A

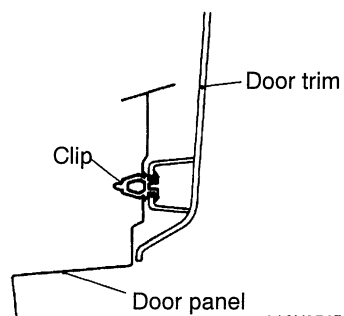

A18U0545

View B

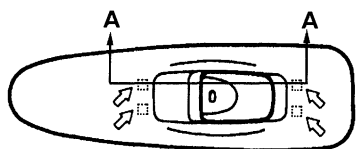

A18U0560

Section A – A

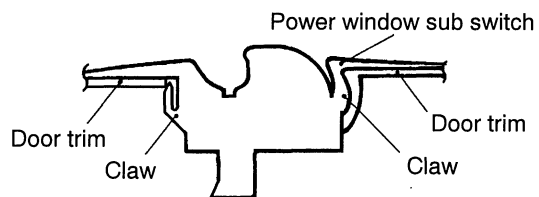

A18U0561

NOTE

- ➡ : Resin clip positions
- ➡ : Claw positions

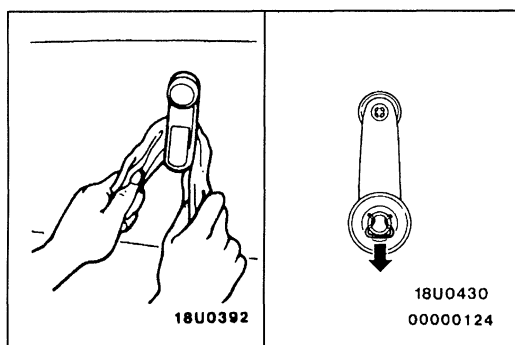
**REMOVAL SERVICE POINT****◀A▶ CLIP REMOVAL**

Remove the clip by using a rag, and then remove the regulator handle.

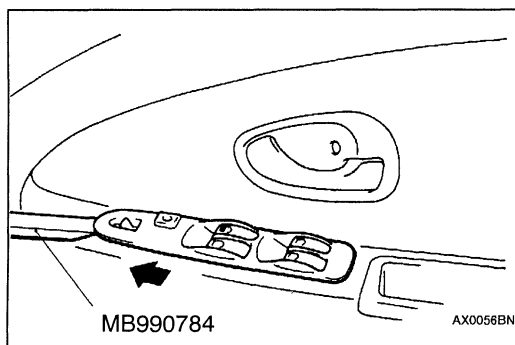
**◀B▶ POWER WINDOW MAIN SWITCH REMOVAL**

Use the special tool to undo the front part of the power window main switch, and then remove the switch by sliding towards the shown direction (Refer to CLIP AND CLAW POSITIONS <FRONT DOOR>).

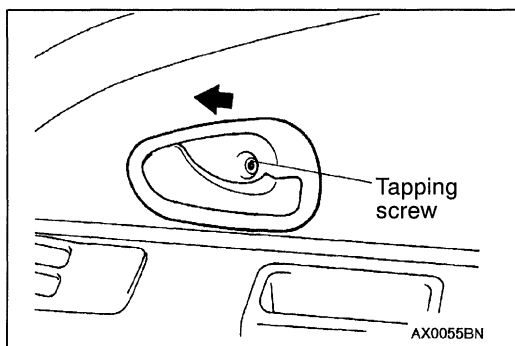
**◀C▶ COVER REMOVAL**

Remove the tapping screw, and then remove the cover by sliding it towards the shown direction.

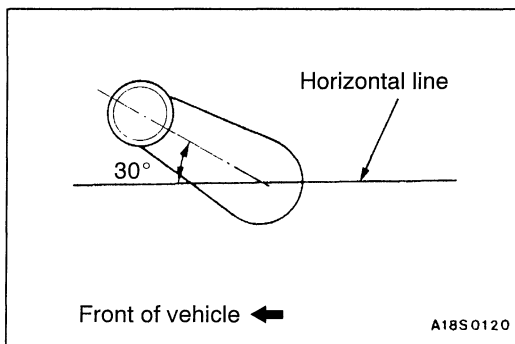
**INSTALLATION SERVICE POINT****▶A◀ REGULATOR HANDLE INSTALLATION**

1. Install the escutcheon and the clip to the regulator handle.
2. Fully close the front door glass, and install the regulator handle so that it faces as shown in the illustration.

DOOR HANDLE AND LATCH

REMOVAL AND INSTALLATION

Pre-removal Operation

Door Trim Removal (Refer to P. 42-13.)

Post-installation Operation

- (1) Door Inside Handle Play Check (Refer to P. 42-11.)
- (2) Door Trim Installation (Refer to P. 42-13.)
- (3) Door Fit Adjustment

Front door

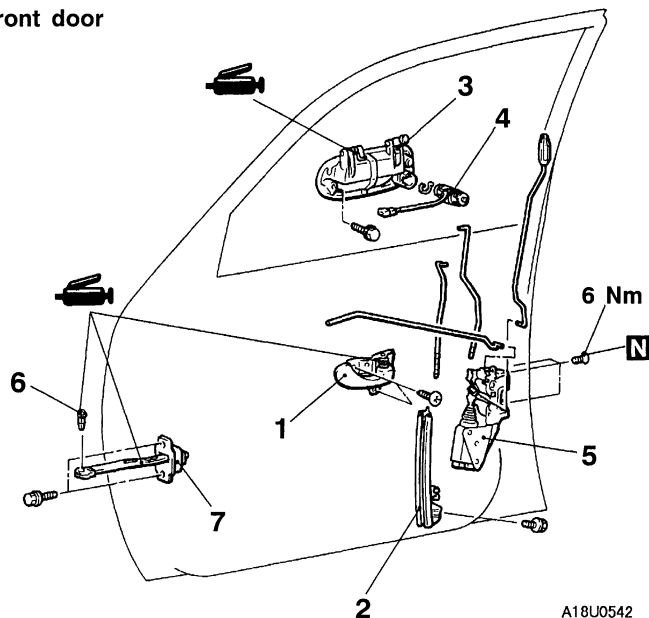

A18U0542

Rear door

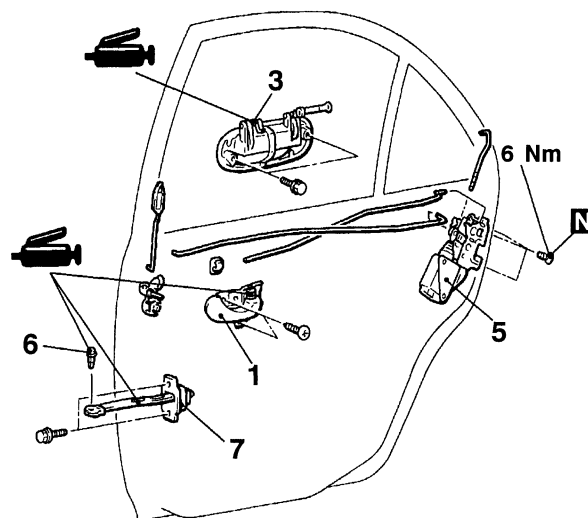

A18U0543

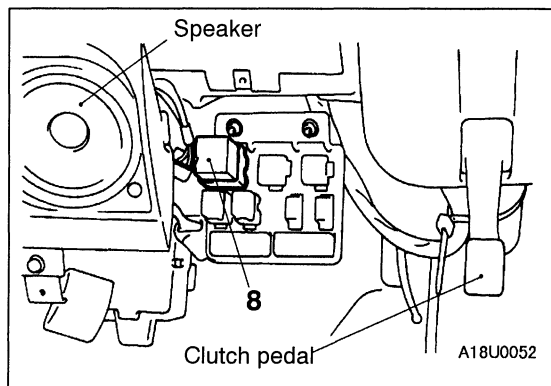

A18U0052

Front door handle and door latch assembly removal steps

1. Door inside handle
 - Waterproof film (Refer to P. 42-13.)
2. Lower sash rear
3. Door outside handle
4. Door lock key cylinder
5. Door latch assembly

Rear door handle and door latch assembly removal steps

1. Door inside handle
 - Waterproof film (Refer to P. 42-13.)
3. Door outside handle
5. Door latch assembly

Door check removal steps

1. Door inside handle
 - Waterproof film (Refer to P. 42-13.)
6. Spring pin
7. Door check



Door lock-ECU removal

8. Door lock-ECU
 - <Vehicles with central door locking system (without keyless entry system)>

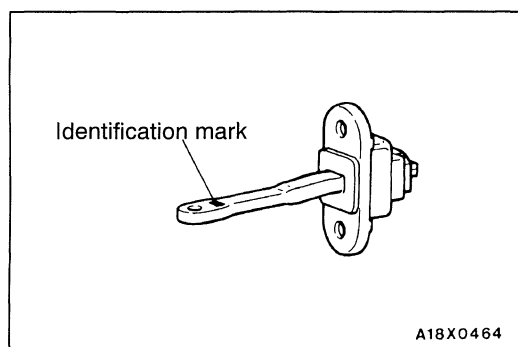
**INSTALLATION SERVICE POINT****►◄ DOOR CHECK INSTALLATION**

Install the door check so that the identification mark faces upwards.

| Applicable location | | Identification mark |
|---------------------|------------|---------------------|
| L.H. | Front door | FL |
| | Rear door | RL |
| R.H. | Front door | FR |
| | Rear door | RR |

TRUNK LID

TROUBLESHOOTING

INSPECTION CHART FOR TROUBLE SYMPTOMS

| Trouble symptom | Reference page |
|---------------------------------------|----------------|
| Door lock mechanism does not operate. | 42-7 |

TRUNK LID

REMOVAL AND INSTALLATION

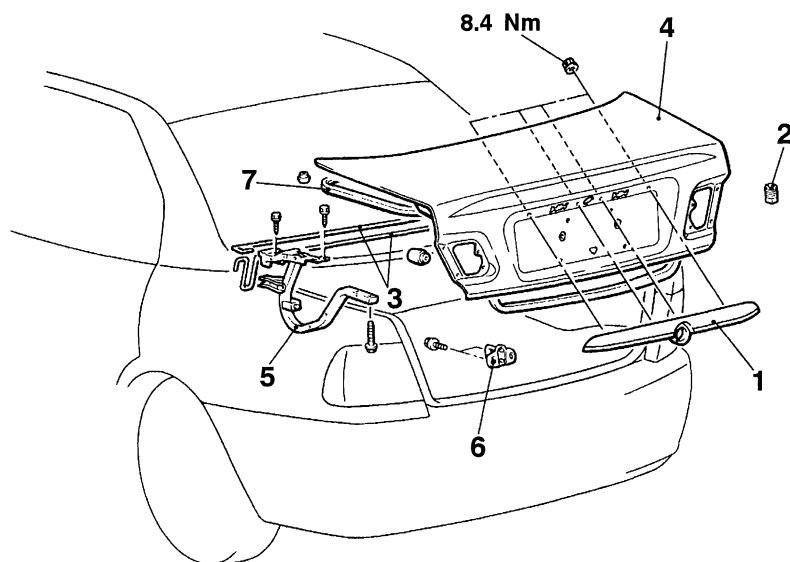

A18U0550

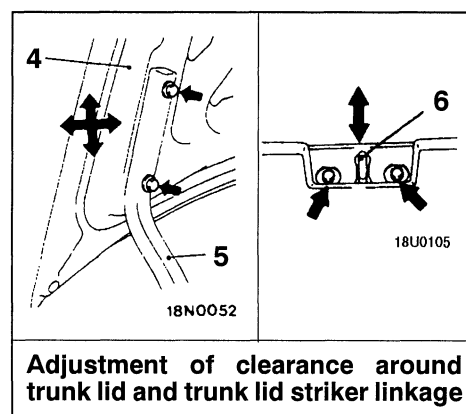

Trunk lid panel removal steps

- Licence plate lamp
 - Rear lid lamp
 - Trunk lid lock
1. Licence plate lamp garnish
 2. Bumper
 3. Trunk lid torsion bar
 4. Trunk lid panel



Trunk lid hinge removal steps

- Rear shelf trim (Refer to GROUP 52A.)
4. Trunk lid panel assembly
 5. Trunk lid hinge

Trunk lid striker removal steps

- Rear end trim (Refer to GROUP 52A.)
6. Trunk lid striker

Trunk lid weatherstrip removal

7. Trunk lid weatherstrip



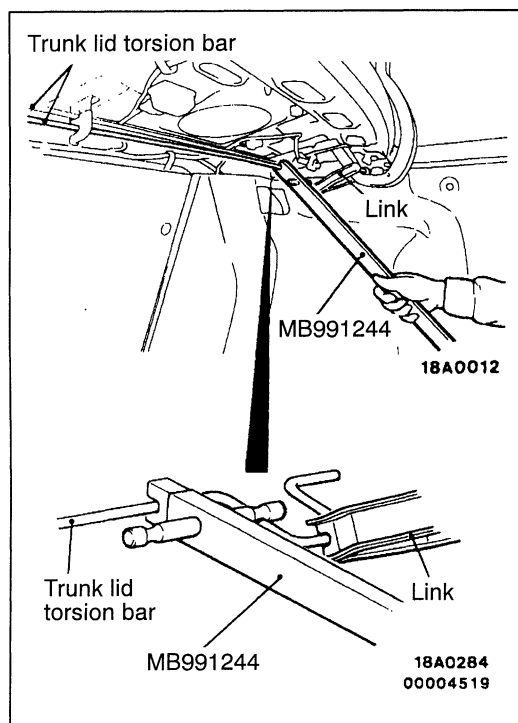

REMOVAL SERVICE POINT

◀A▶ TRUNK LID TORSION BAR REMOVAL

1. Disconnect the body harness and the harness connector of the rear shelf lower panel.
2. Install the special tool as shown in the illustration, and then remove the torsion bar from the link while pushing the special tool downwards. Next, repeat the procedure from the other side.

Caution

Be sure to attach the special tool properly, as the body or parts could be damaged when the torsion bar is removed from the special tool.

INSTALLATION SERVICE POINTS

▶A◀ TRUNK LID WEATHERSTRIP INSTALLATION

Install the trunk lid weatherstrip so that the marking and the joint are aligned with the body centre line.

▶B◀ TRUNK LID TORSION BAR INSTALLATION

1. Check the colour of the identification mark at the middle of the torsion bars to make sure that the correct torsion bars are being used.

| Torsion bar | Identification colour | |
|-------------|-------------------------------|----------------------------|
| | Vehicles without rear spoiler | Vehicles with rear spoiler |
| L.H. | – | Blue |
| R.H. | White | Red |

2. Insert the end of the torsion bar through the link side mating hole.
3. Install the special tool in the same way as when removing the torsion bar, and then twist the torsion bar while hooking it onto the link. After this, hook the torsion bar onto the holder.

Caution

Be sure to attach the special tool properly, as the body or parts could be damaged when the torsion bar is removed from the special tool.

TRUNK LID LATCH REMOVAL AND INSTALLATION

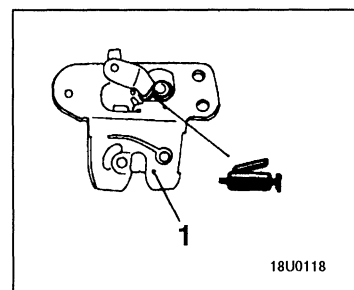
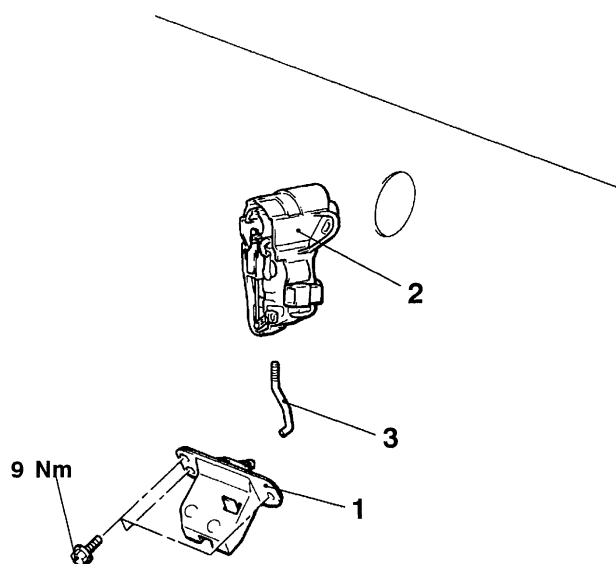

A18U0540

Removal steps

1. Trunk lid latch
2. Trunk lid lock key cylinder switch and trunk lid lock actuator
3. Trunk lid lock

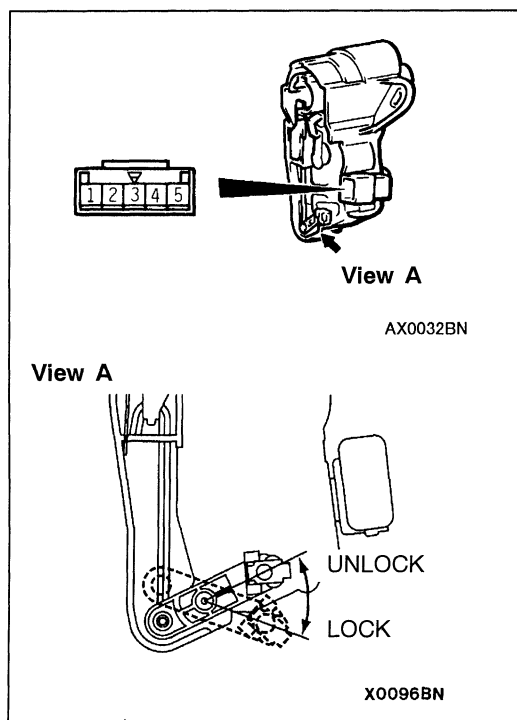

INSPECTION

TRUNK LID LOCK KEY CYLINDER SWITCH AND TRUNK LID LOCK ACTUATOR CONTINUITY CHECK

| Rod position | Terminal No. | | | | | Rod position |
|---------------|--------------|---|---|---|---|----------------------------------|
| | 1 | 2 | 3 | 4 | 5 | |
| LOCK | ⊕ | ⊖ | | | | LOCK position to UNLOCK position |
| UNLOCK | ⊖ | ⊕ | | | | UNLOCK position to LOCK position |
| LOCK | | | ○ | ○ | | |
| Neutral (OFF) | | | | | | |
| UNLOCK | | | | ○ | ○ | |

TAILGATE

TROUBLESHOOTING

INSPECTION CHART FOR TROUBLE SYMPTOMS

| Trouble symptom | Reference page |
|-----------------------------------|----------------|
| Door lock mechanism does operate. | 42-7 |

TAILGATE ASSEMBLY

REMOVAL AND INSTALLATION

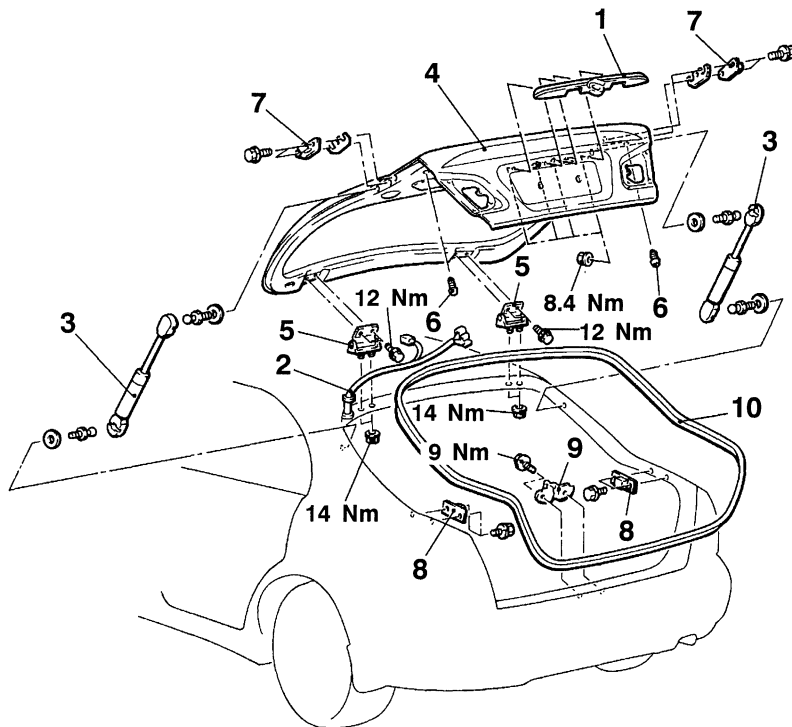

18U0551

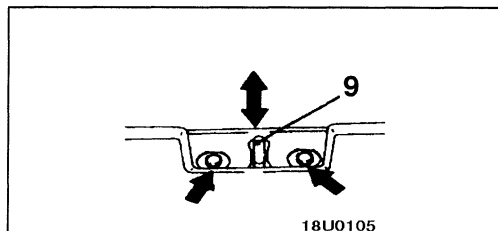
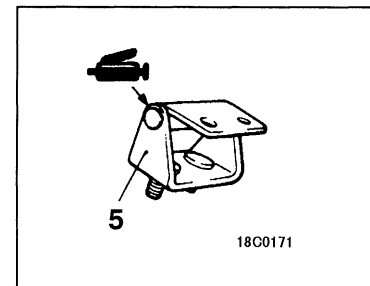

Adjustment of tailgate step and tailgate striker linkage

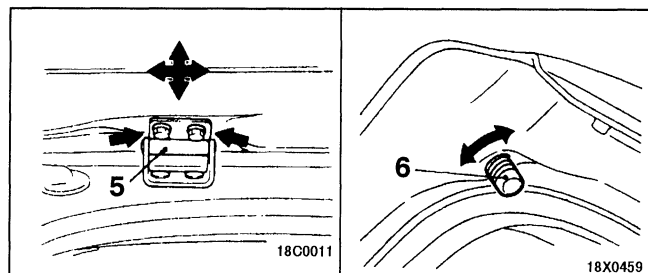

Adjustment of clearance around tailgate

Tailgate and tailgate hinge removal steps

- Tailgate trim (Refer to P. 42-25.)
- Rear fog lamp
- Tailgate lock
- License plate lamp
- 1. License plate lamp garnish
- 2. Harness connection
- 3. Tailgate gas spring
- 4. Tailgate assembly
- Rear roof rail trim
- 5. Tailgate hinge
- 6. Bumper
- 7. Damper upper
- 8. Damper lower

Tailgate striker removal steps

- Rear end trim (Refer to GROUP 52A.)
- 9. Tailgate striker

Tailgate opening weatherstrip removal

- A◀ 10. Tailgate opening weatherstrip

◀A▶

►B◀

REMOVAL SERVICE POINT**◀A▶ TAILGATE GAS SPRING REMOVAL****Caution**

1. Never try to disassemble the tailgate gas spring or burn it.
2. Always bore a hole in the tailgate gas spring to release the interior gas before the gas spring is discarded.

INSTALLATION SERVICE POINTS**▶A◀ TAILGATE OPENING WEATHERSTRIP INSTALLATION**

Install the tailgate opening weatherstrip so that the joint is at the centre of the body.

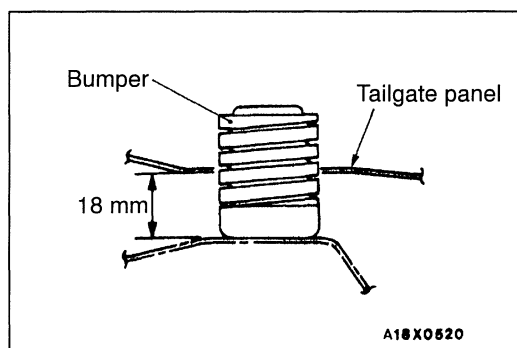
**▶B◀ BUMPER INSTALLATION**

Install the bumper so that the amount of projection from the tailgate panel is as shown in the illustration.

TAILGATE TRIM

REMOVAL AND INSTALLATION

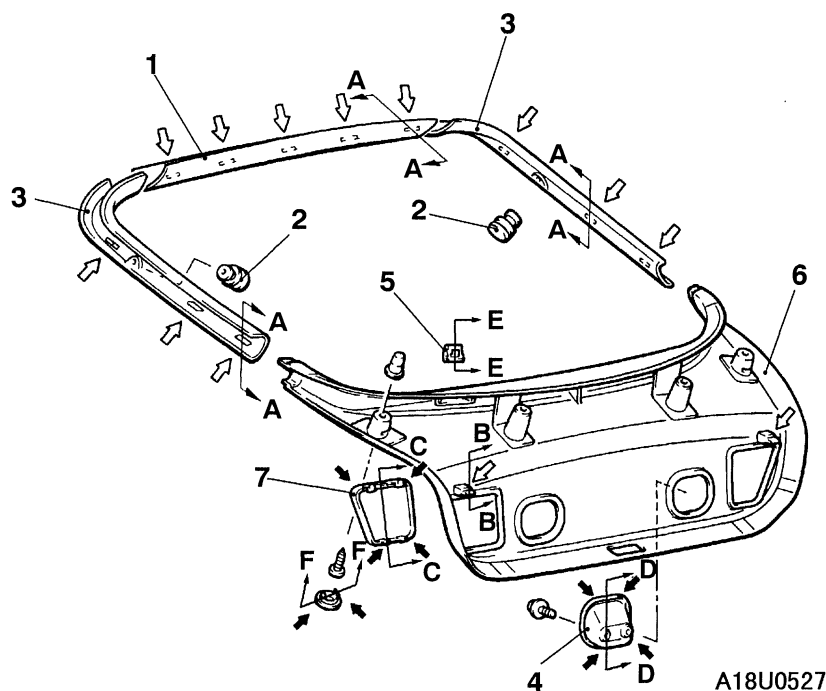

NOTE

- ⇐ : Metal clip positions
 ⇐ : Claw positions

Section A – A

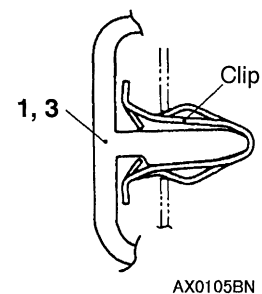

Section B – B

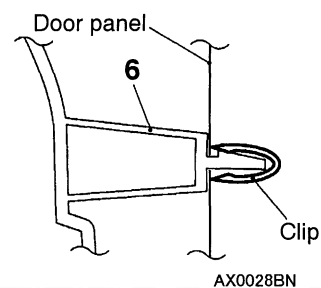

Section C – C

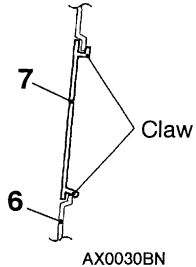

Section D – D

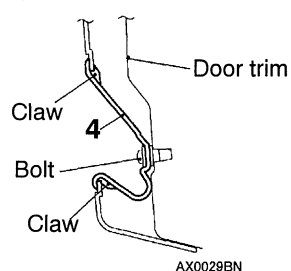

Section E – E

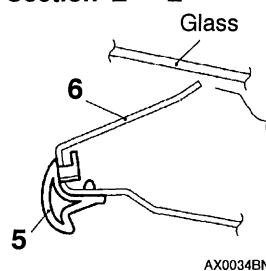

Section F – F

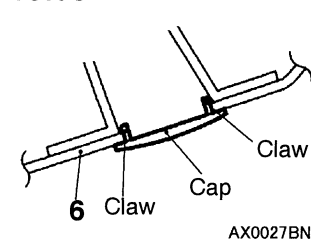

Removal steps

1. Tailgate upper trim
2. Tailgate trim hook
3. Tailgate side trim
4. Tailgate grip box

5. Shelf damper
6. Tailgate lower trim
7. Lid

TAILGATE LATCH

REMOVAL AND INSTALLATION

Pre-removal and Post-installation Operation

- Tailgate Lower Trim Removal and Installation (Refer to P.42-25.)

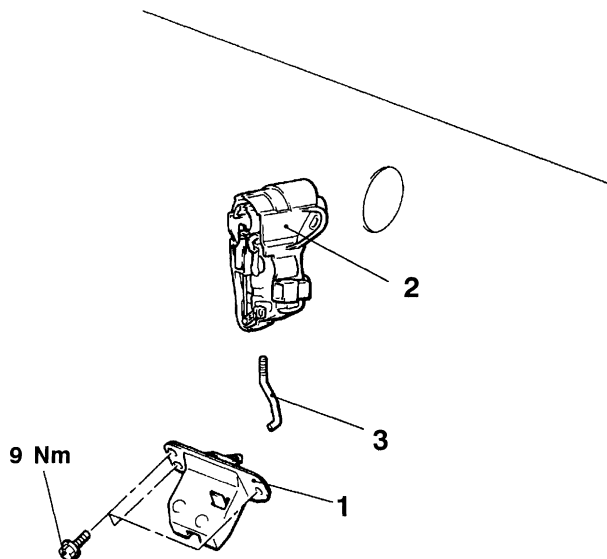

A18U0540

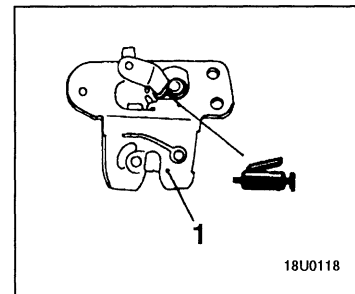

Removal steps

1. Tailgate latch
2. Tailgate lock key cylinder switch and tailgate lock actuator
3. Tailgate rod

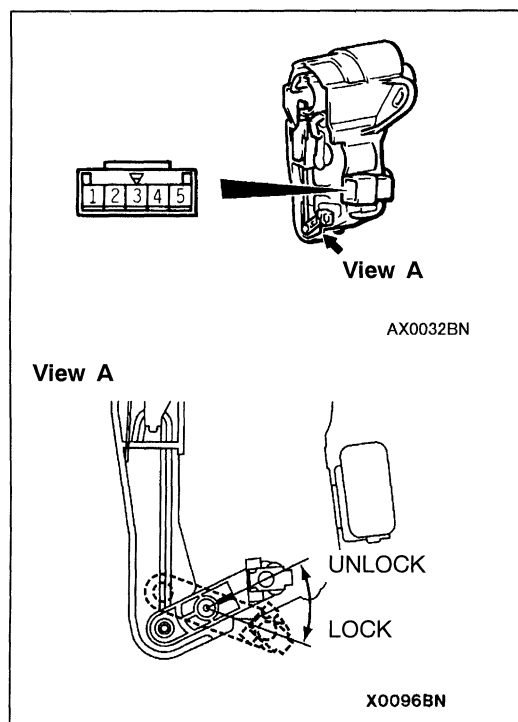

INSPECTION

TRUNK LID LOCK KEY CYLINDER SWITCH AND TRUNK LID LOCK ACTUATOR CONTINUITY CHECK

| Rod position | Terminal No. | | | | | Rod position |
|---------------|--------------|---|---|---|---|----------------------------------|
| | 1 | 2 | 3 | 4 | 5 | |
| LOCK | ⊕ | ⊖ | | | | LOCK position to UNLOCK position |
| UNLOCK | ⊖ | ⊕ | | | | UNLOCK position to LOCK position |
| LOCK | | | ○ | ○ | | |
| Neutral (OFF) | | | | | | |
| UNLOCK | | | | ○ | ○ | |

KEYLESS ENTRY SYSTEM

TROUBLESHOOTING

INSPECTION CHART FOR TROUBLE SYMPTOMS

| Trouble symptoms | | Inspection procedure | Reference page |
|----------------------|---|----------------------|----------------|
| Keyless entry system | None of the doors, including the tailgate, can be locked or unlocked. (However, the central door locking system is functioning normally.) | 1 | 42-27 |
| | All of the doors, including the tailgate, can be locked and unlocked, but the hazard lamp does not illuminate or does not flash. (However, the hazard lamp flashes normally when the hazard lamp switch is used.) | 2 | 42-27 |
| | Secret codes cannot be registered. | 3 | 42-28 |

INSPECTION PROCEDURE FOR TROUBLE SYMPTOMS

Inspection Procedure 1

| None of the doors, including the tailgate, can be locked or unlocked. (However, the central door locking system is functioning normally.) | Probable cause |
|--|---|
| The transmitter battery may be spent, the secret code may not have been registered correctly, or there may be a malfunction of the transmitter. If the transmitter is normal, the cause is probably a malfunction of the keyless entry receiver-ECU. | <ul style="list-style-type: none"> • Malfunction of the battery • Malfunction of the transmitter • Malfunction of the keyless entry receiver-ECU |

```

graph TD
    A[Replace the transmitter battery (refer to '96 CARISMA Basic Manual.) and then press the transmitter LOCK or UNLOCK switch.  
OK: Indicator lamp illuminates] -- OK --> B[Re-register the secret code.(Refer to P.42-29.)]
    A -- NG --> C[Replace the transmitter.]
    B -- OK --> D[Check trouble symptoms.]
    B -- NG --> E[Replace the keyless entry receiver-ECU.]
    D -- NG --> E
    
```

Inspection Procedure 2

| All of the doors, including the tailgate, can be locked and unlocked, but the hazard lamp does not illuminate or does not flash. (However, the hazard lamp flashes normally when the hazard lamp switch is used.) | Probable cause |
|---|--|
| The keyless entry receiver-ECU or the harness between hazard lamp and keyless entry receiver-ECU may be defective. | <ul style="list-style-type: none"> • Malfunction of the keyless entry receiver-ECU • Malfunction of harness or connector |

```

graph TD
    A[Measure at the keyless entry receiver-ECU connector B-99.  
• Disconnect the connector and measure at the harness side.  
• Continuity between 27 and body earth  
• Continuity between 28 and body earth  
OK: Continuity] -- OK --> B[Replace the keyless entry receiver-ECU.]
    A -- NG --> C[Check the following connectors.  
B-99, B-79]
    C -- OK --> D[Check trouble symptoms.]
    C -- NG --> E[Repair]
    D -- NG --> F[Check the harness wire between keyless entry receiver-ECU and intermediate connector, and repair if necessary.]
    
```

Inspection Procedure 3

| Secret codes cannot be registered. | Probable cause |
|---|---|
| One of the following items may be defective. Diagnosis connector Keyless entry receiver-ECU power supply circuit Earth circuit Diagnosis output circuit | <ul style="list-style-type: none"> • Malfunction of the keyless entry receiver-ECU • Malfunction of the MUT-II • Malfunction of harness or connector |

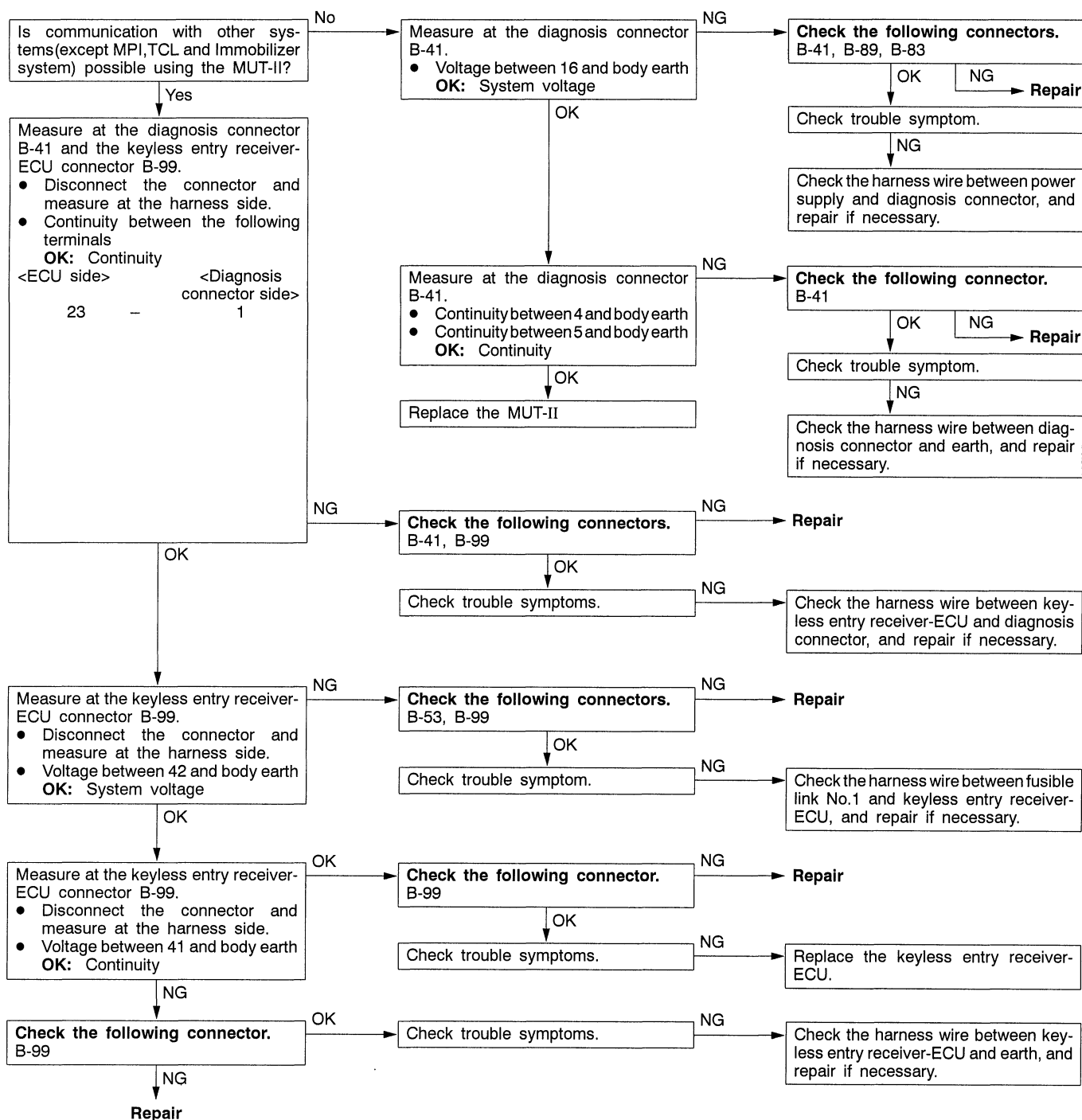

INSPECTION AT KEYLESS ENTRY RECEIVER-ECU TERMINALS**TERMINAL VOLTAGE CHART**

1. Measure the voltages between terminal (41) (earth terminal) and each respective terminal.
2. The terminal arrangements are shown in the illustrations below.

| | | | | | | | | | | | | | | | | | | |
|---|----|----|----|----|----|----|----|----|----|----|----|----|----|----|----|----|----|----|
| 1 | 2 | 3 | 4 | 5 | 6 | 7 | 8 | 21 | 22 | 23 | 24 | 25 | 26 | 27 | 28 | 29 | 30 | 31 |
| 9 | 10 | 11 | 12 | 13 | 14 | 15 | 16 | 32 | 33 | 34 | 35 | 36 | 37 | 38 | 39 | 40 | 41 | 42 |

18U0130

| Connector Terminal No. | Signal | Checking Requirements | Normal Condition |
|------------------------|---|----------------------------|------------------|
| 21 | Door lock output | When operating | System voltage |
| | | When not operating | 0 V |
| 22 | Ignition switch | Ignition switch: ACC or ON | System voltage |
| | | Ignition switch: OFF | 0 V |
| 23 | Diagnostic selection (Input) | MUT-II : Connected | 0 V |
| | | MUT-II : Disconnected | Approx. 4V |
| 42 | Keyless entry receiver-ECU power supply | Always | System voltage |
| 27, 28 | Hazard warning lamp | When lamp is switched off | 0 V |
| | | When lamp illuminates | System voltage |
| 41 | Earth | Always | 0 V |

ON-VEHICLE SERVICE**SECRET CODE REGISTRATION METHOD**

Each individual secret code is registered inside the transmitter, and so it is necessary to register these codes with the EEPROM inside the receiver in the following cases.

- When either the transmitter or receiver is replaced;
- If a second transmitter is to be used;
- If it appears that a problem is occurring because of faulty registration of a code.

A maximum of two different codes can be stored in the memory area of the EEPROM (two different transmitters can be used). When the code for the first transmitter is registered, the previously-registered codes for four transmitters are cleared. Therefore, if you are using more than two transmitters or are adding a second transmitter, the codes for all the transmitters must be registered at the same time.

1. Check that the doors lock normally when the key is used.
2. Insert the ignition key to the ignition switch.

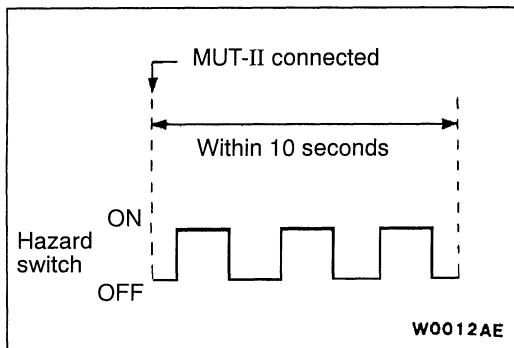
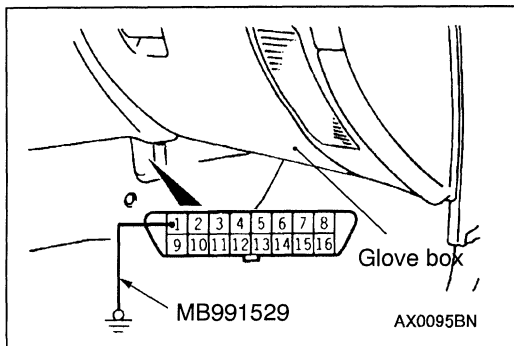

3. Connect the MUT-II to the diagnosis connector.

NOTE

This will connect terminal (1) of the diagnosis connector to earth, and the system will be in secret code registration standby mode.

Caution

Always turn the ignition switch to OFF before connecting and disconnecting the MUT-II.

4. Within 10 seconds after connecting the MUT-II, press the hazard switch six times.

NOTE

The doors will lock and unlock once at this time and the system will switch to registration mode.

5. Press the lock switch or unlock switch of the transmitter switch, and then press it two times within 10 seconds of the first press. This will register the code.
6. After registration is completed, the doors will be automatically locked and unlocked once.
7. If you are using more than two transmitters or have added a second transmitter, the same registration procedure should be carried out for the remaining transmitters, and it should be carried out within one minute after registration of the code for the first transmitter has been completed. The registration procedure are all the same for all transmitters.
8. Registration mode will be terminated under the following conditions.
 - When the secret codes for four transmitters have been registered;
 - When one minute has passed after registration mode started;
 - If the MUT-II is disconnected (earth is released);
 - If the ignition switch is turned to ON;
 - If one of the doors are opened;
9. After registration mode has been completed, carry out the followings to make sure that the keyless entry system operates.
 - Pull the ignition key out.
 - Close the all windows.